

Upper Floor Plan  
(2,360 sq. ft. or 219.3 m<sup>2</sup>)

6 Bedrooms / 4.5 Baths  
Living / Dining / Kitchen  
Family Room / Study / Foyer  
(Total 4,120 sq. ft. or 382.8 m<sup>2</sup>)

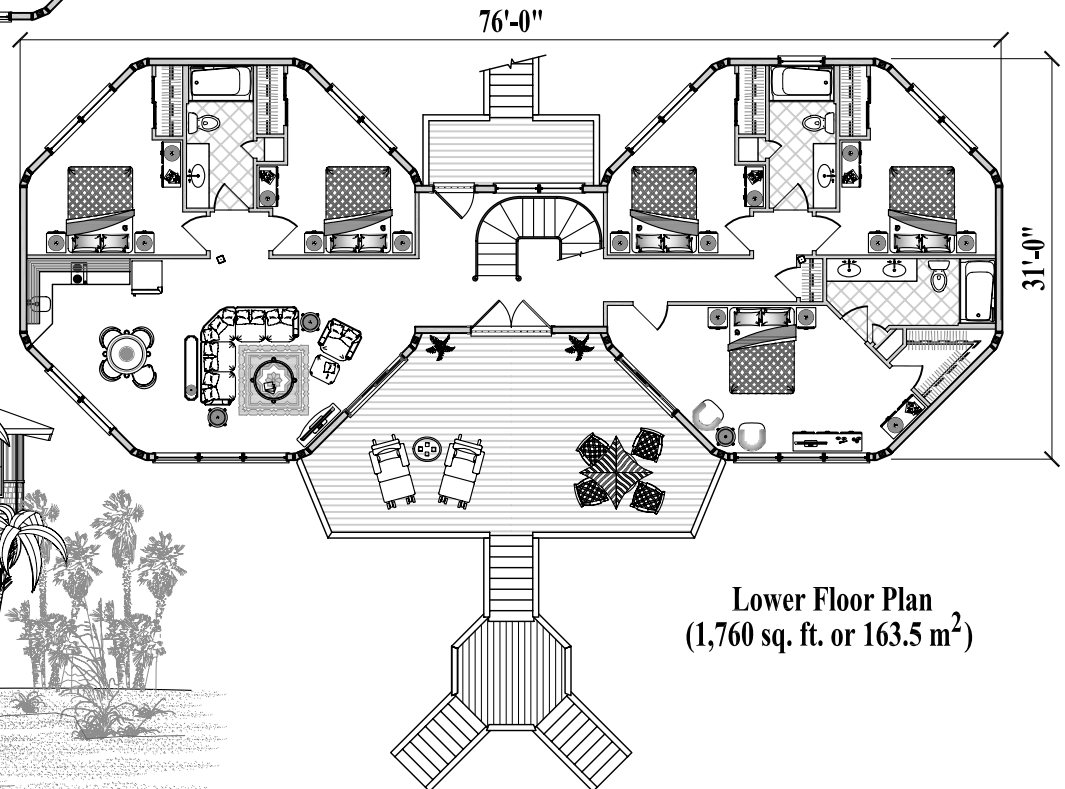

Lower Floor Plan  
(1,760 sq. ft. or 163.5 m<sup>2</sup>)

